

# Kemet

## Precision Diamond Flat Lapping & Polishing Machines Series 48



Picture of Kemet 48  
pneumatic lapping  
machine without Kemet  
Diamond Dispensing  
System

The Kemet 48 Lapping Machine is equipped with a 48 inch (1219mm) diameter serrated lap plate. The lap plate consists of 16 cast iron individual segments bolted to a support plate.

Kemet 48 lapping machines are available in Open Face or Pneumatic lift versions. The primary function of the pneumatic arrangement is to permit loading and unloading to be carried out without the need to lift the pressure weights manually. However, they can also be used to supply additional loading to the components within the conditioning ring should this be required.

Operator safety is a primary concern in the design. Movement of each pressure weight up or down is controlled by a two hand anti-tie down control box. This arrangement requires the use of both hands on two separate buttons to function and ensures that the operator cannot injure his hands or arms when lowering the weights.

A further safety feature is that the pressure weights are mechanically latched when in the raised position, so that should the compressed air supply or electrical power fail, the weights will not fall.

The machine can be used with conventional abrasives slurries or Kemet Diamond slurries. The conventional abrasive supply system consists of a floor standing tank fitted with a separately powered paddle type agitator. Abrasive slurry is pumped to four adjustable outlets which feed individual track wires. The Diamond Dispensing system consists of a electronic dispenser for fully controlled metering of liquid diamond and lubricating fluid, Liquid diamond stirrer unit, dual dispensing bars and spray heads.

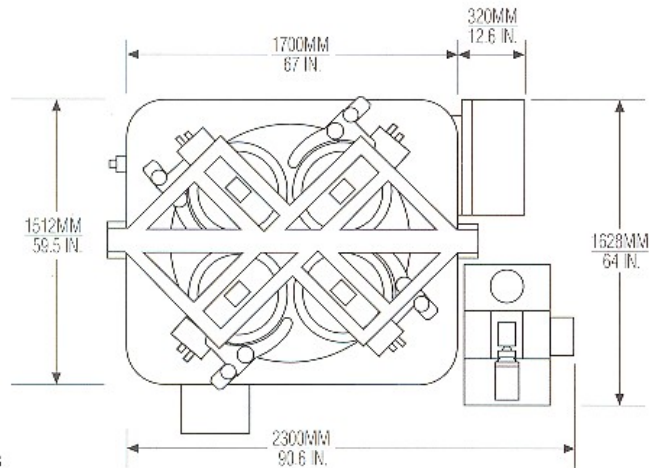
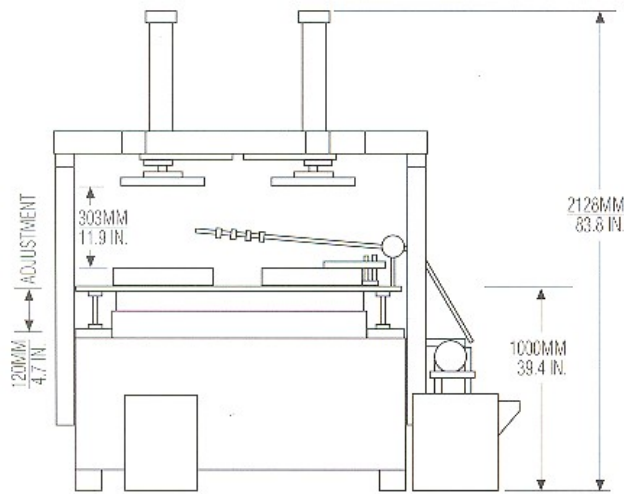

Weight: 3944kg/8696 lbs  
Shipping weight: 4853kg/10,700 lbs

## Standard Tooling

- High density, cast iron serrated lapping plate (16 segments) 48" O.D. x 13" I.D. (1219mm O.D. x 330mm I.D.).
- Four high density cast iron serrated conditioning rings 20" O.D. x 17" I.D. (508mm O.D. x 432mm I.D.).
- Four work holder blanks.
- Four felt pads.
- Starter sample of abrasive.
- Starter sample of vehicle.
- Operation and Maintenance Manual.
- Allen Keys.

## Standard Features

- Heavy duty floor standing base with integrally mounted drive motor, reduction gearbox, abrasive distribution system, complete with control panel.
- Heavy duty work table, vertically adjustable.
- Range of loads for pressure weights (machine connected to 4 bar supply) 47kg / 103lbs to 488kg / 1077lbs. Controls for raise / lower are of two hand anti-tie down type.
- Four conditioning rings, with adjustable roller bearing yoke assemblies to maintain lap flatness.
- Abrasive feed system designed for water or oil based lapping slurries with pump driven stirrer tank and multiple point distribution.
- Operator control panel with start and stop controls, and multiple range automatic cycle timer.
- High torque drive unit with 7.5kW / 10hp motor and gear reducer. Lap plate speed 48 rpm.
- Electrical system wired for 220V 3 phase 50 Hz or 380V 3 phase 50Hz or 415V 3 phase 50Hz.
- Waste container.

## Available Options

- 3-ring model.
- Variable speed lap plate drive.
- Water cooled lap plate.
- Non-standard voltages.
- Customised machines and tooling.